

Service-Information



Group 46 Frame	August 1981	Bulletin No. 46 005 81 (2038)
-------------------	----------------	----------------------------------

- For U.S.A. and Canada Only -

Subject: 1981 RT Windshield Mounting.

1. Cut off center nipple and the nipples at each end of the rubber gasket. (2)
2. Install holders, No: 7 and No: 8 onto the windshield using counter - sunk head screws.
3. Insert No: 3 holder through windshield and install O-Rings on holder stud.
4. Lubricate remaining rubber nipples with silicone or other similar product, using needle nose pliers - pull each nipple through its hole in the windshield.
5. Glue rubber gasket to the windshield only at points where nipples were cut off.
6. Adjust the windshield for height and ensure it is even, then secure all fastenings, but do not over tighten.

Yours truly,

A handwritten signature in dark ink, appearing to read 'Herb Neas', written over a circular stamp.

Herb Neas
National Service Manager

Enclosure

/bb

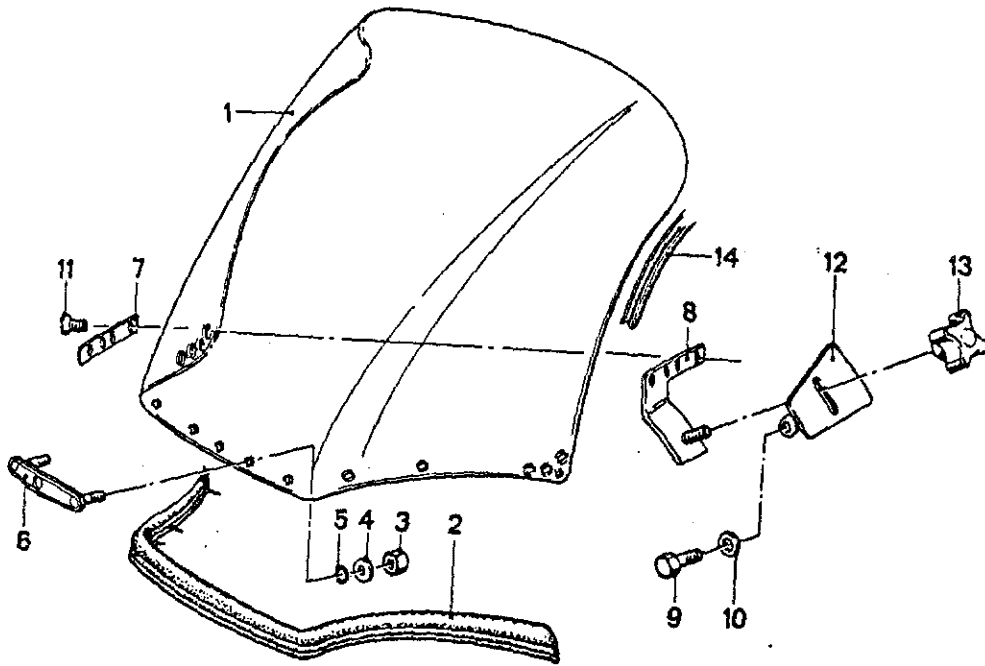

6
27
10/80

**Fg→ 12/79

Nr.	Teile-Nummer	Symbol	Benennung	USA	R 50/5	R 60/5	R 75/5	R 60/6	R 75/6	R 90/6	R 90 S	R 60/7	R 75/7	R 80/7	R 100/7	R 100 S	R 100 RS	R 60 T	R 75 T	R 80 T	R 100 T	R 100 RT
1	46 63 1 240 621		Windschutzscheibe / Windshield / Windscherm / Vindskydd	+														1	1	1	1	1
2	46 63 1 240 649		Dichtung / Gasket / Pakking / Packning	+														1	1	1	1	1
3	07 11 9 922 410		6KT MU M 5	+														2	2	2	2	2
4	07 11 9 931 036		5,3 Scheibe / Washer / Ring / Bricka	+														2	2	2	2	2
5	46 63 1 241 080		DT RG	+														2	2	2	2	2
6	46 63 1 241 031		Klemmblech / Clamping plate / Klemplaatje / Klämplåt	+														1	1	1	1	1
7	46 63 1 240 653	L	dito	+														1	1	1	1	1
	46 63 1 240 654	R	dito	+														1	1	1	1	1
8	46 63-1 240 637	L	Halter / Holder / Steun / Hållare	+														1	1	1	1	1
	46 63 1 240 638	R	dito	+														1	1	1	1	1
9	07 11 9 913 432		6KT SHR M 6 x 10	+														4	4	4	4	4
10	07 11 9 931 044		6,4 Scheibe / Washer / Ring / Bricka	+														6	6	6	6	6
11	07 11 9 928 117	A	SK SHR M 5 x 8	+														6	6	6	6	6
	a07 11 9 928 120		SK SHR M 5 x 10	+														6	6	6	6	6
12	46 63 1 240 655	L	Grundplatte / Base plate / Grondplaat / Bottemplatta	+														1	1	1	1	1
	46 63 1 240 656	R	dito	+														1	1	1	1	1
13	46 63 1 240 747		Kreuzgriff / Star handle / Kruissleutel / Handtag	+														2	2	2	2	2
14	46 63 1 239 874		Kantenschutz / Chafing strip / Randbescherming / Kantskydd	+														1	1	1	1	1